

Ventajas de los racores tipo Vebeo

Desviación (3° max.)

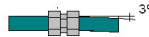

Excelente comportamiento ante las vibraciones

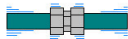

Ahorro de materiales, tubos mas finos



Desmontable y reutilizable

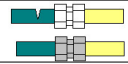

Facilidad y ahorro de tiempo en el montaje

Sin otra preparación que quitar las rebabas del tubo
Se acepta un defecto de escuadra del tubo de hasta 5°
Montaje sin herramientas (2 llaves son suficientes)

Precauciones limitadas

Solamente se requiere respetar los pares de apriete

Instrucciones de montaje

Quitar rebabas del extremo del tubo

Montar los elementos del racor en este orden:

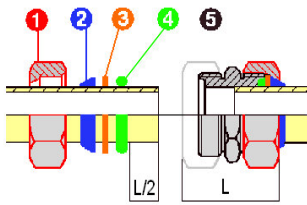

- 1 Tuerca
- 2 Anillo cónico
- 3 Arandela
- 4 Junta tórica

Introducir el tubo en el racor a una distancia inferior a 1/2 de L

Apretar la tuerca con el par indicado en la tabla

Precauciones

En las uniones rectas que no se toquen los tubos en el racor.

Para el racor de rosca macho el hexagonal del machón debe de hacer tope con la cara de implantación.

El racor y el tubo deben estar necesariamente bloqueados en rotación al apretar la tuerca.

Una vez apretado el conjunto verificar que las extremidades del anillo cónico no estén en contacto.

Si este fuera el caso, verificar la compatibilidad entre los diámetros del tubo y del racor o la tolerancia del tubo.

| DIAMETO TUBO | | PRESION MAXIMA | |
|--------------|-----|----------------|--|
| inch | m/m | bar | |
| | 6 | 200 | |
| | 8 | | |
| 1/8 | 10 | | |
| | 12 | 100 | |
| 1/4 | 14 | | |
| | 16 | | |
| 3/8 | 17 | | |
| | 18 | | |
| | 20 | | |
| 1/2 | 21 | 80 | |
| | 25 | | |
| 3/4 | 27 | | |
| | 30 | 40 | |
| 1 | 34 | | |
| 1 1/4 | 42 | | |
| | 45 | | |
| 1 1/2 | 48 | | |
| 2 | 60 | | |

| D/ TUBO | PAR DE APRIETE (daN.M) | | | | |
|---------|------------------------|------|-------|------|-------|
| | inch | m/m | ACERO | INOX | COBRE |
| | 6 | 3,2 | 3,2 | 1,6 | |
| | 8 | 4 | 4 | 2 | |
| 1/8 | 10 | 4,7 | 4,7 | 2,5 | |
| | 12 | 5 | 5 | 2,8 | |
| 1/4 | 14 | 6 | 6 | 3,2 | |
| | 16 | 7 | 7 | 3,6 | |
| 3/8 | 17 | 8 | 8 | 4 | |
| | 18 | 9,5 | 9,5 | 4,8 | |
| | 20 | 9,5 | 9,5 | 4,8 | |
| 1/2 | 21 | 10 | 10 | 5 | |
| | 25 | 12,5 | 12,5 | 6,3 | |
| 3/4 | 27 | 14 | 14 | 7 | |
| | 30 | 16 | 16 | 8 | |
| 1 | 34 | 18 | 18 | 9 | |
| 1 1/4 | 42 | 25 | 25 | 12,5 | |
| | 45 | 30 | 30 | 15 | |
| 1 1/2 | 48 | 37 | 37 | 15 | |
| 2 | 60 | 42 | 42 | 21 | |

DESIGNACION DE LOS RACORES

| 2 MATERIAL | 4 MEDIDAS | | | | 6 ANILLO CONICO | | | | | | | | | |
|--------------------|-----------|---------|--------------|---------------|-----------------|-----------|----------------|-----------------|-------------|------------|-----------------|------------|------------|-----------------|
| | A ACERO | L LATON | X INOXIDABLE | C CATAFORESIS | DT D/TUBO | dt d/TUBO | RM ROSCA MACHO | RH ROSCA HEMBRA | A ADAPTADOR | BCA - LISO | BCAS - ESTRIADO | BCL - LISO | BCX - LISO | BCXS - ESTRIADO |
| UNION SIMPLE | U | 2 | 3 | DT | | + | 6 | | | | | | | |
| UNION REDUCIDA | UR | 2 | 3 | DT | dt | + | 6 | | | | | | | |
| PASATABIQUE | PC | 2 | 3 | DT | | + | 6 | | | | | | | |
| TAPON | B | 2 | 3 | DT | | + | 6 | | | | | | | |
| OBTURADOR | OV | 2 | 3 | DT | | + | 6 | | | | | | | |
| UNION MACHO | UM | 2 | 3 | DT | RM | + | 6 | | | | | | | |
| UNION HEMBRA | UF | 2 | 3 | DT | RH | + | 6 | | | | | | | |
| CODO IGUAL | E | 2 | 3 | DT | | + | 6 | | | | | | | |
| TE IGUAL | T | 2 | 3 | DT | | + | 6 | | | | | | | |
| CRUZ IGUAL | C | 2 | 3 | DT | | + | 6 | | | | | | | |
| ADAPTADOR REDUCIDO | AUR | 2 | 3 | A | DT | + | 6 | | | | | | | |
| ADAPTADOR MACHO | AM | 2 | 3 | A | RM | | | | | | | | | |
| ADAPTADOR HEMBRA | AF | 2 | 3 | A | RH | | | | | | | | | |
| PASAMAMPARO | PP | 2 | 3 | DT | | + | 6 | | | | | | | |
| CODO MACHO | EM | 2 | 3 | DT | RM | + | 6 | | | | | | | |
| TE REDUCIDA | TR | 2 | 3 | DT | dt | + | 6 | | | | | | | |
| ORIENTABLE | OR | 2 | 3 | DT | RM | + | 6 | | | | | | | |
| REDUCTOR RM-RH | RI | | | RM | RH | | | | | | | | | |

Uniones tubo

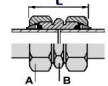

UA
Unión doble

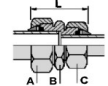

URA
Unión reducida

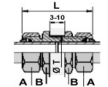

PCA
Pasatabiques

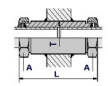

PPA
Pasamamparo

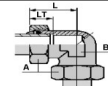

EA
Codo igual

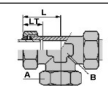

TA
Te igual

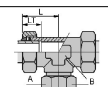

TRA
Te Reducida

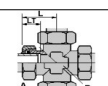

CA
Cruz

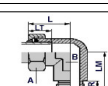

EMA
Codo macho

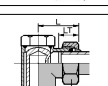

ORA
Orientable

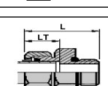

UMA
Unión macho

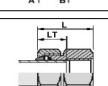

UFA
Unión hembra

Adaptadores

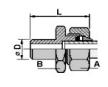
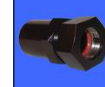

AURA
Adaptador reducido

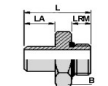

AMA
Adaptador macho

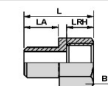

AFA
Adaptador hembra



RI
Reducción macho hembra

Tapones

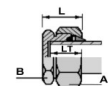
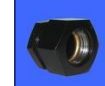

BA
Tapón



OVA
Obturator